

AURUMDESIGN



Stock Finishes:

- USi 5 - Satin Nickel (Stem)
- USi 9 - Flat Black

Model

S110-TP

Height-

6 "

Width

3 "

Projection

1.4"

EXCLUSIVE DOOR HARDWARE



Precise
Mechanical
Driving



IP66
Waterproof



Corrosion
Resistant

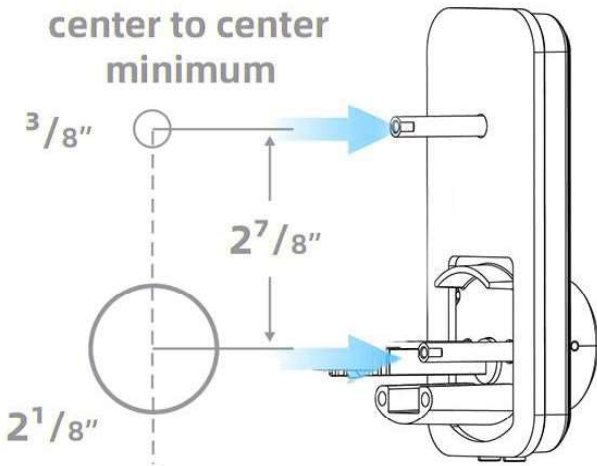

In order to fasten door lock,
you need to drill an extra hole.

6 1/2 in

6 in

1 1/2-- 1 7/8 in



Passcode and Sharing



Touchscreen Keypad



Full App Control



Key Free



Auto lock



Battery Back-up

Easy Installation





Lock/Unlock via PIN Code

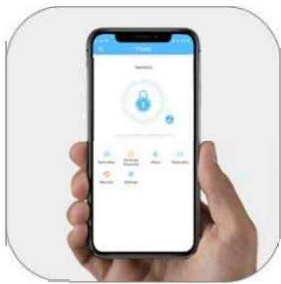

Lock/Unlock via APP



Lock/Unlock via Physical Key



Lock/Unlock Manually

Multi-function unlock



Operation Records

All unlocked records will be synced to the APP when you turn on Bluetooth and read the record

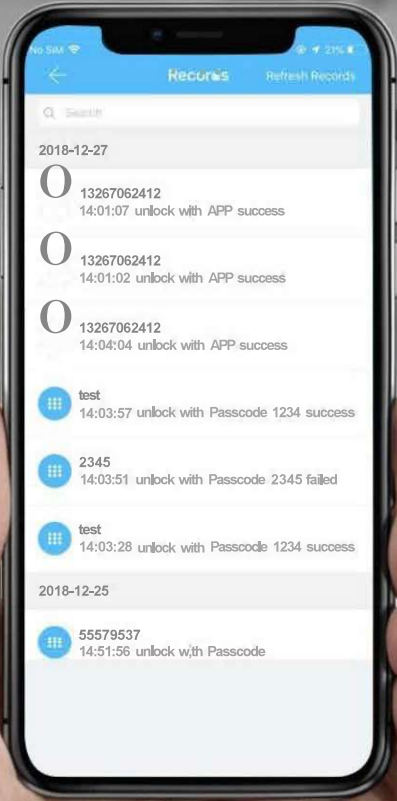

Installers &
User guide
Smart Deadbolt

S110TB
Touchpad

Table of Contents

04

In The Box

05

Specifications

06

Requirements

07

Lock Anatomy

08

Preparing Door for Installation

10

Prepare Lock for Installation

11

Installation Instructions

16

Test Lock

17

Preparing the Door Frame

18

Pairing

19

Features

20

Unlocking

21

Locking

22

Lock Tutorial

25

Lock Behavior

26

Troubleshoot

In The Box

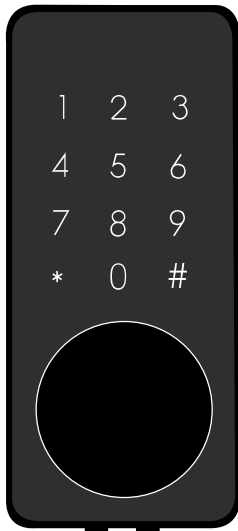

Front Assembly

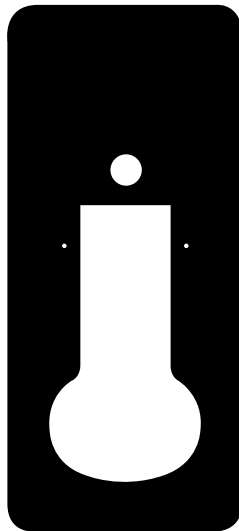

Rubber Gasket

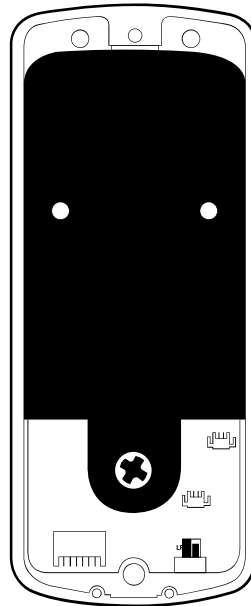

Back Assembly

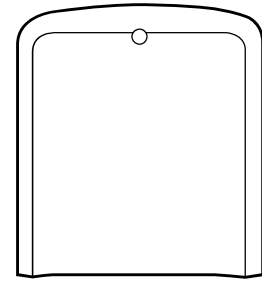

Battery Case Lid

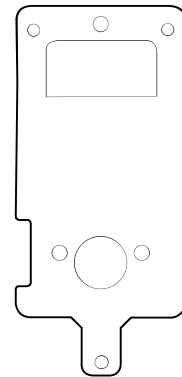

Back Plate

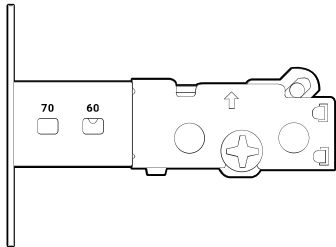

Bolt Assembly

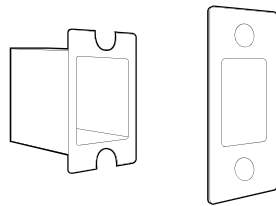

Strike Plate Housing & Strike Plate



Screw Holder

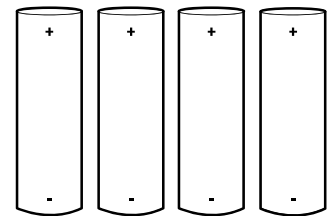

Batteries x 4

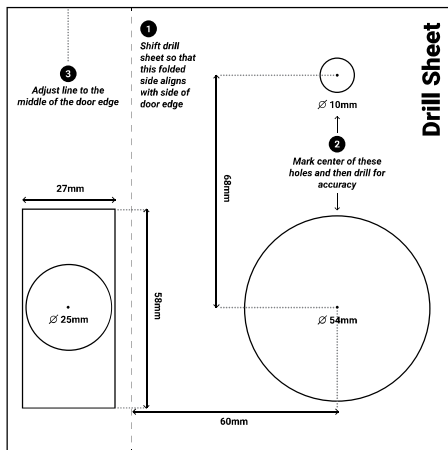

Drill Sheet



5mm Bolt Screw x 2

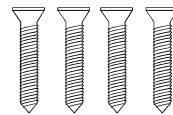

25mm Wood Screw x 4

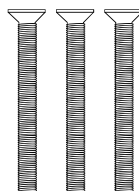

40mm Bolt Screw x 3



22mm Bolt Screw



80mm Tailpiece

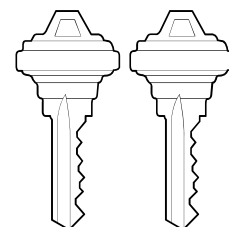

Keys x 2

Specifications

Model	S-110TB
Material	Zinc Alloy
Current Rating (Standby)	$\leq 30\mu\text{A}$
Current Rating (Active)	$\leq 200\text{mA}$
Batteries	4 x AA Alkaline (Non-Rechargeable)
Unlock Mechanism	Bluetooth, Passcode, Keys

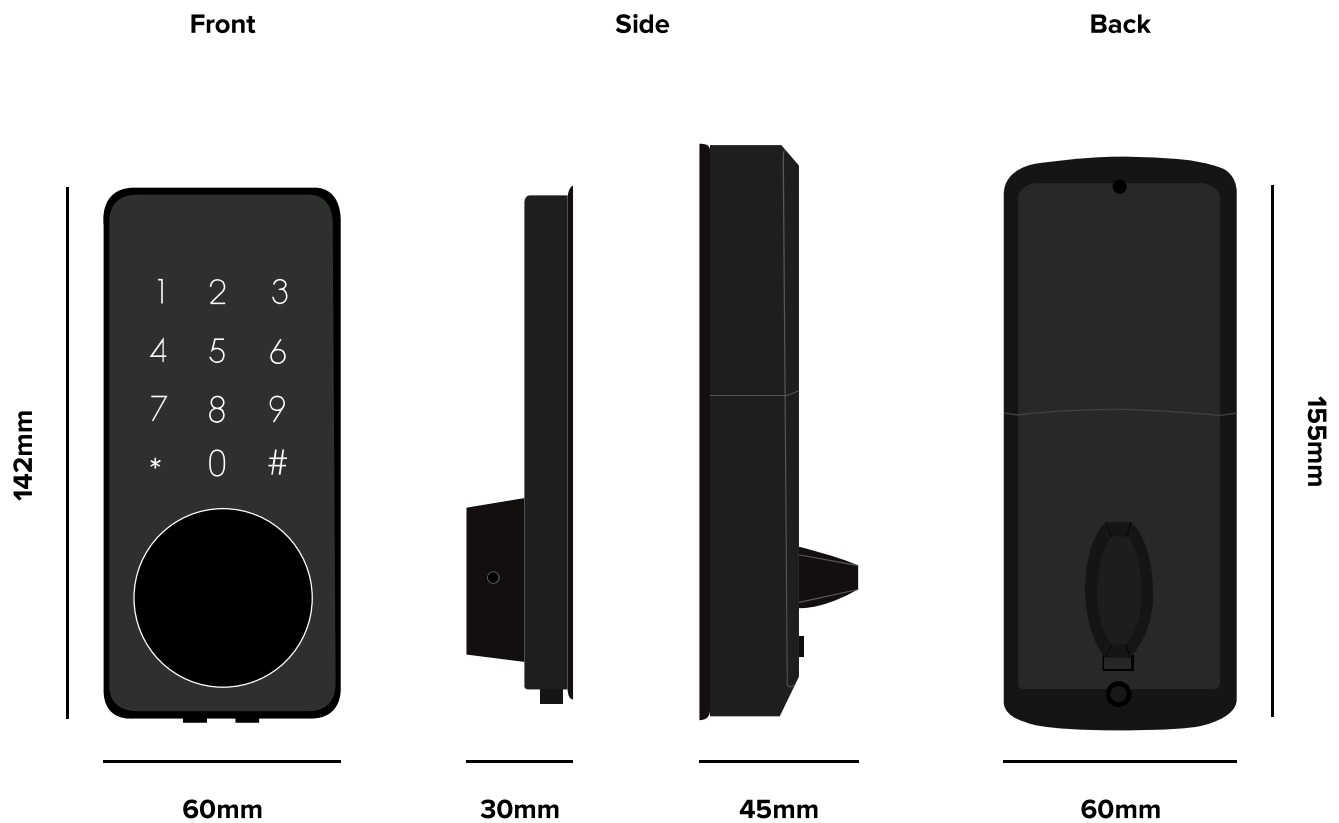

Requirements

Door Thickness & Gate Clearance

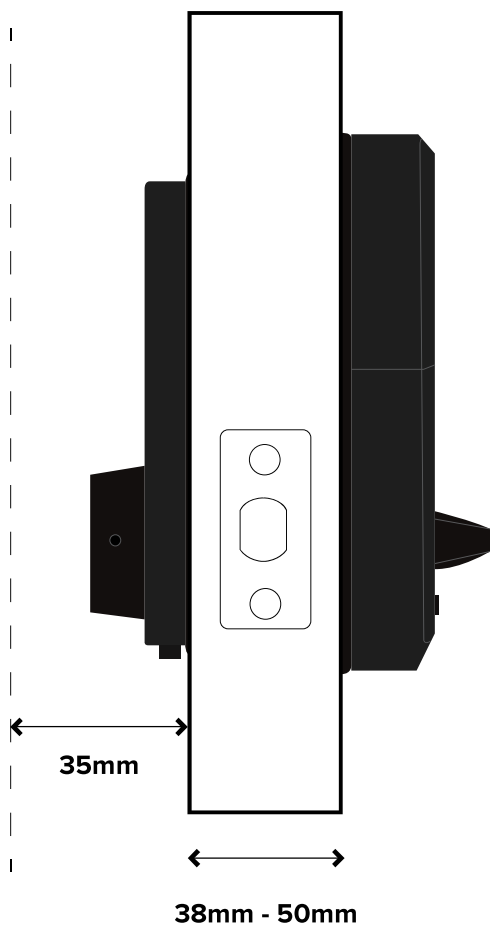

Height & Width

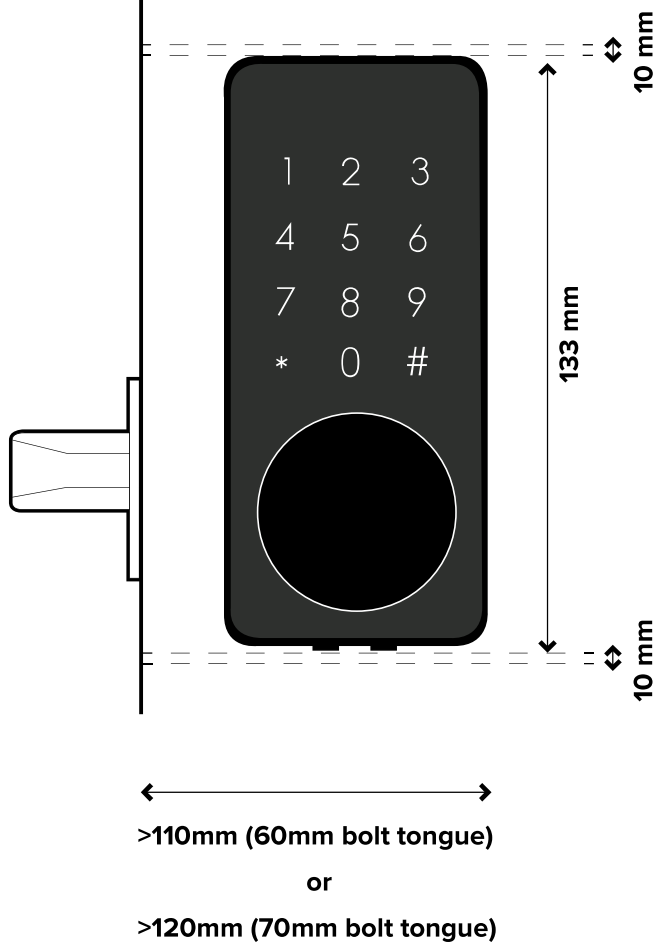

Lock Anatomy

Outer Body

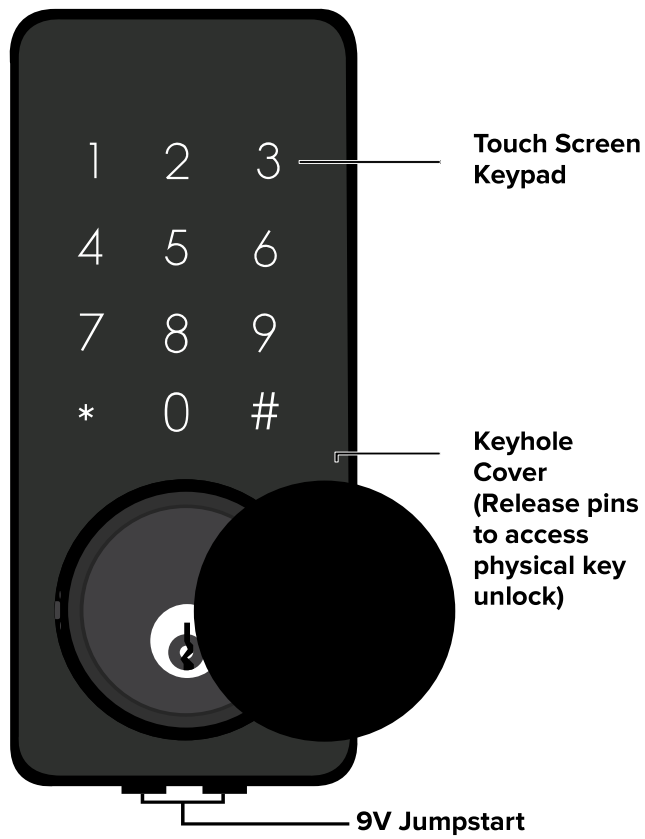

Inner Body

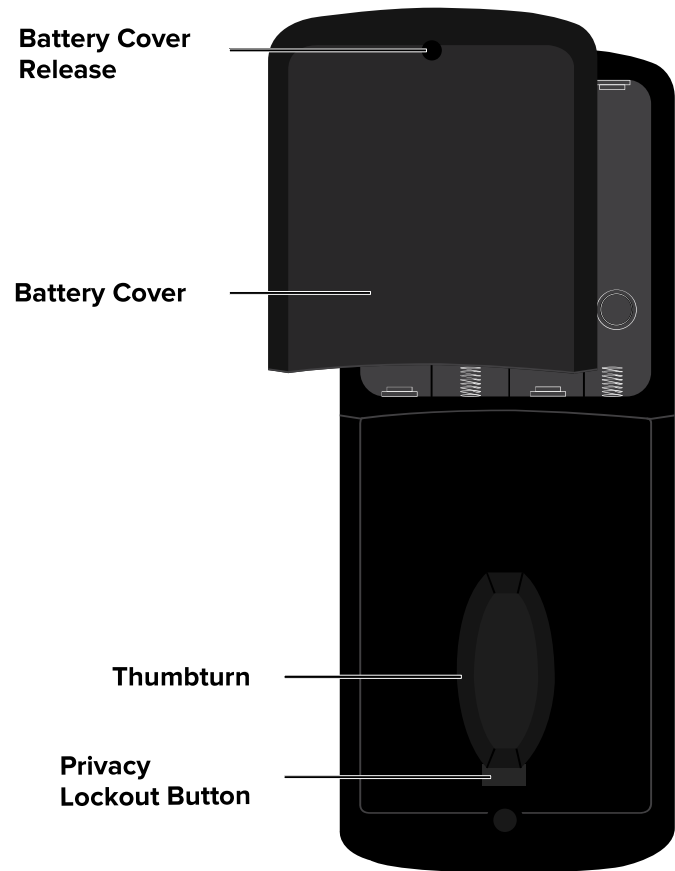

Preparing Door for Installation

Items needed:

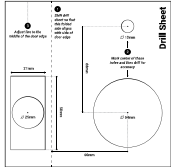

Drill Sheet

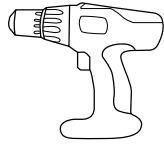

Drill

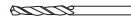

10mm Drill Bit

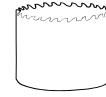

54mm Hole Saw

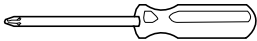

#2 Phillips Screw Driver



20mm Spade Bit

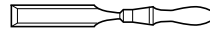

20mm Chisel

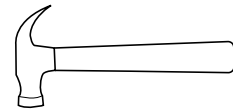

Hammer

Recommended

Door and door frame material: **Wood**

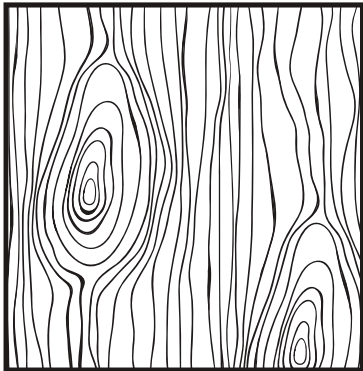

Recommended

Gap between door and door frame: **< 3mm**

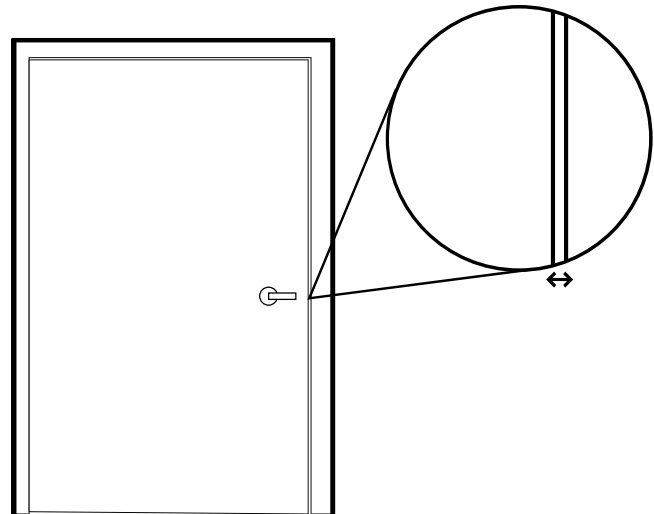

* Please ensure that there is an existing handle on your door for push - pull access.

* **Not for: metal gates, glass doors or sliding doors.**

If you are unsure if your door is suitable, contact us at: support@linnea-home.com

How to use the Drill Sheet

Drilling (Door)

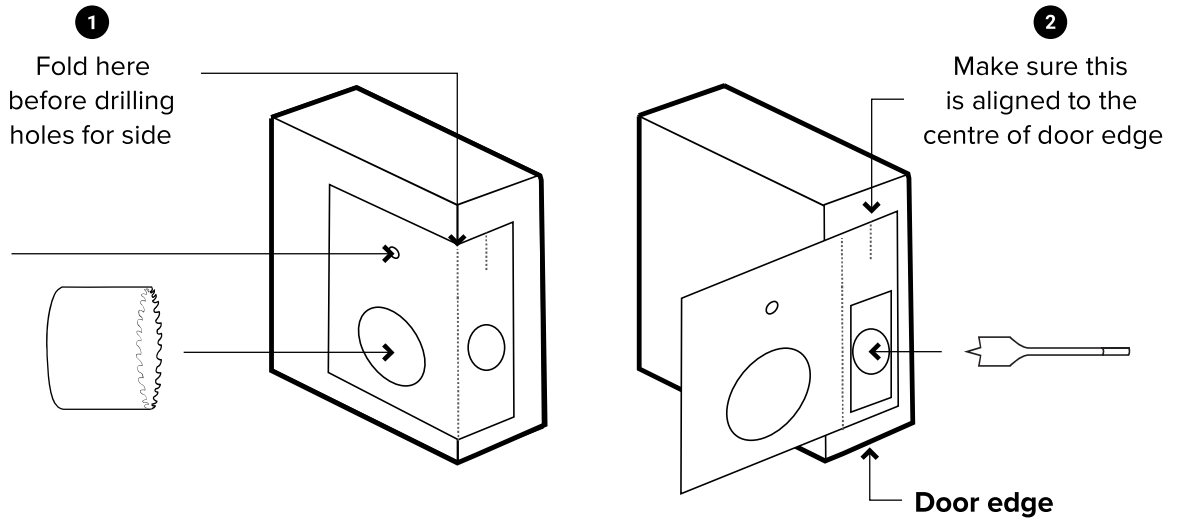

Chiseling

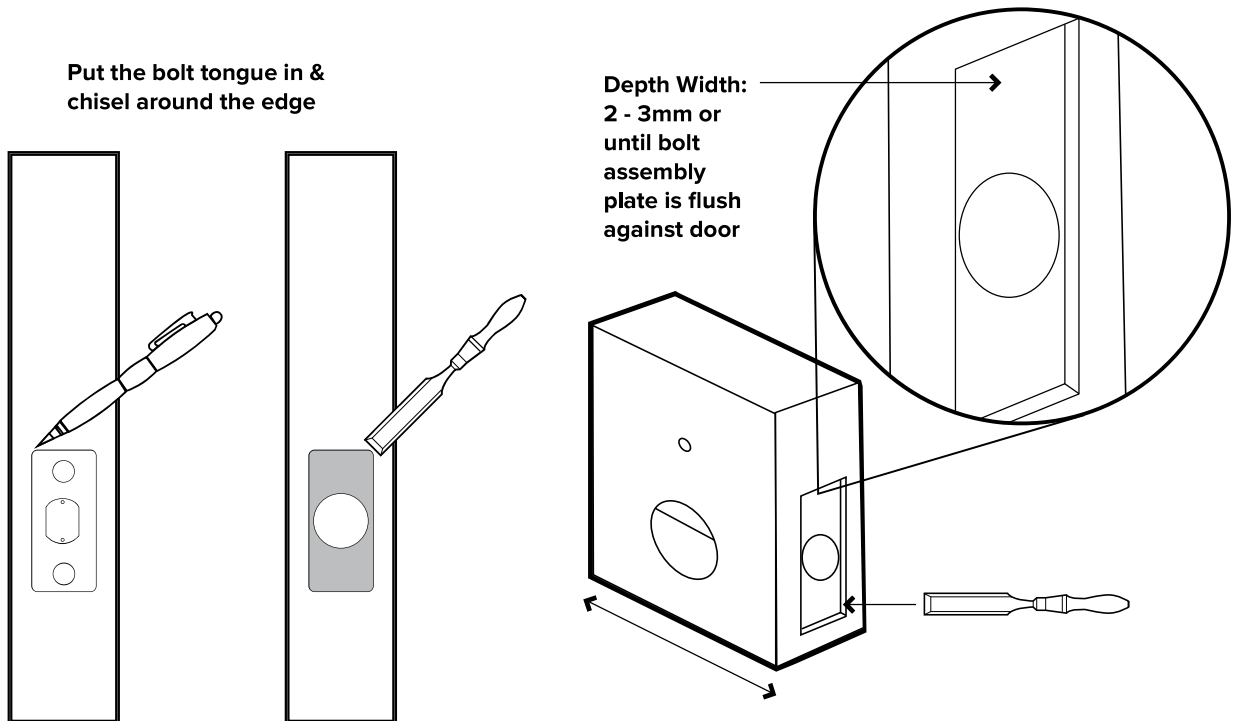

* Mark the center of the holes and then drill for accuracy.

Prepare Lock For Installation

1 Set Back Assembly for Left / Right Installation

Left Installation
Set the toggle to 'R' for right-side installation.

Right Installation
Set the toggle to 'L' for left-side installation.

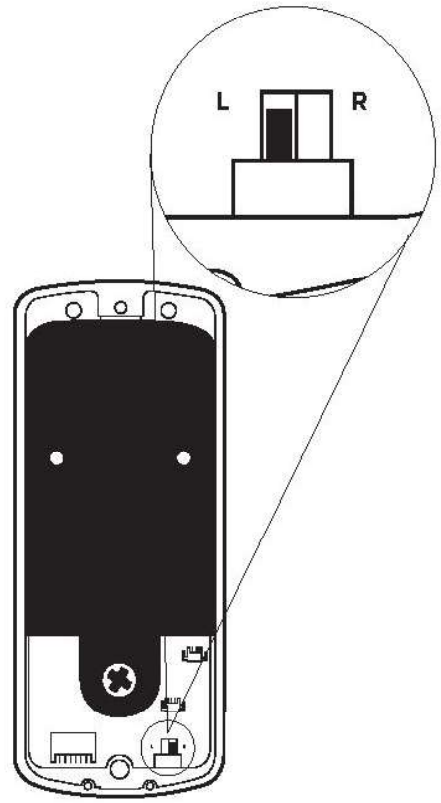
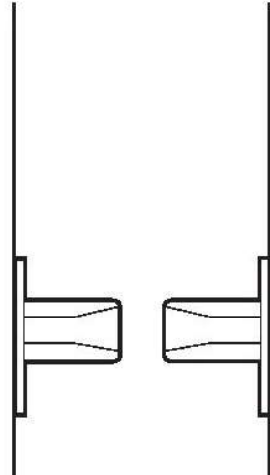

Entry Door Handing Guide



Left Hand
Inswing



Right Hand
Inswing

2 Remove Battery Cover

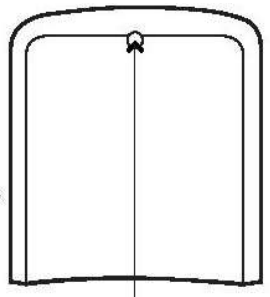
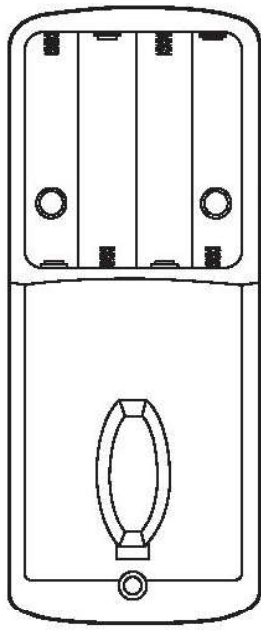

Use a sharp object
to depress the pin
and pull battery case
upwards

Installation Instructions

1 Measure

If you are replacing your current deadbolt lock, industry standards are 60mm or 70mm backset. To determine which basket length you should use, so measure the distance (x) between the center of 54mm hole to door edge.

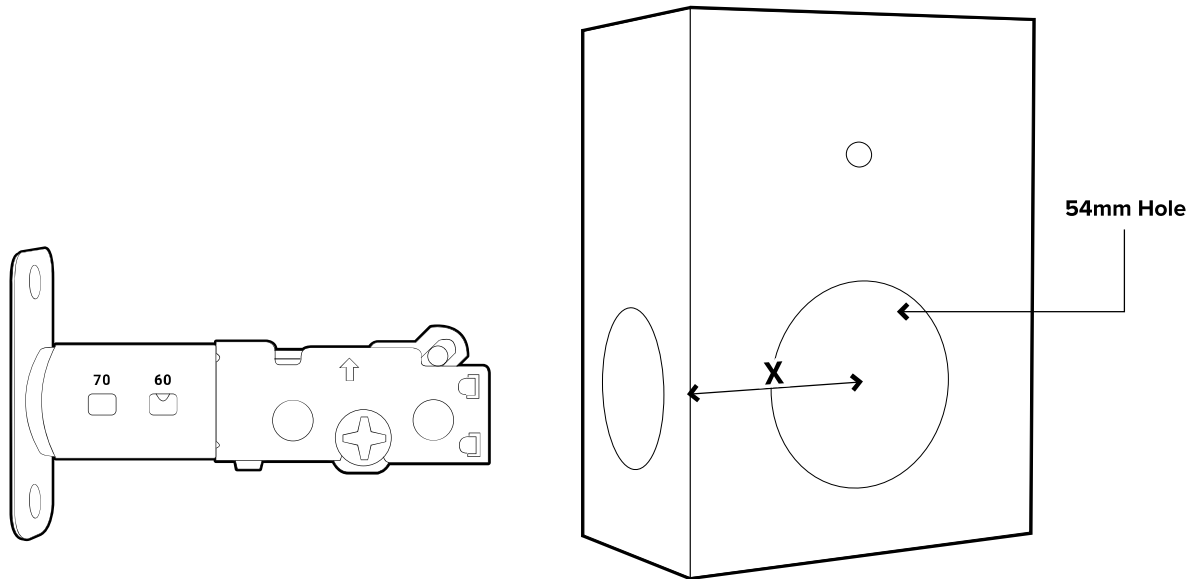

Prepare bolt assembly based on the distance (x)

Bolt ships with bolt assembly in 60mm position. If required, twist the bolt and pull to extend (simultaneously) to 70mm backset position (current drill dimensions are fitted for 60mm position).

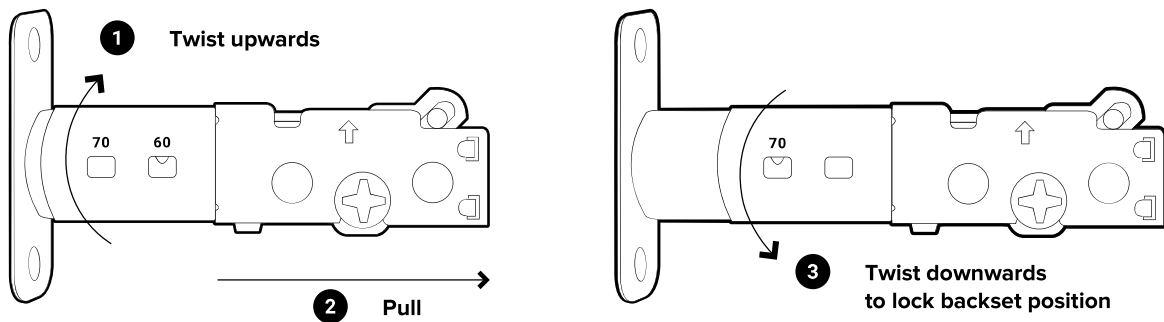

2

Insert Bolt and Front Assembly into door edge

The '+' hole on the backset should be in the middle of the hole.

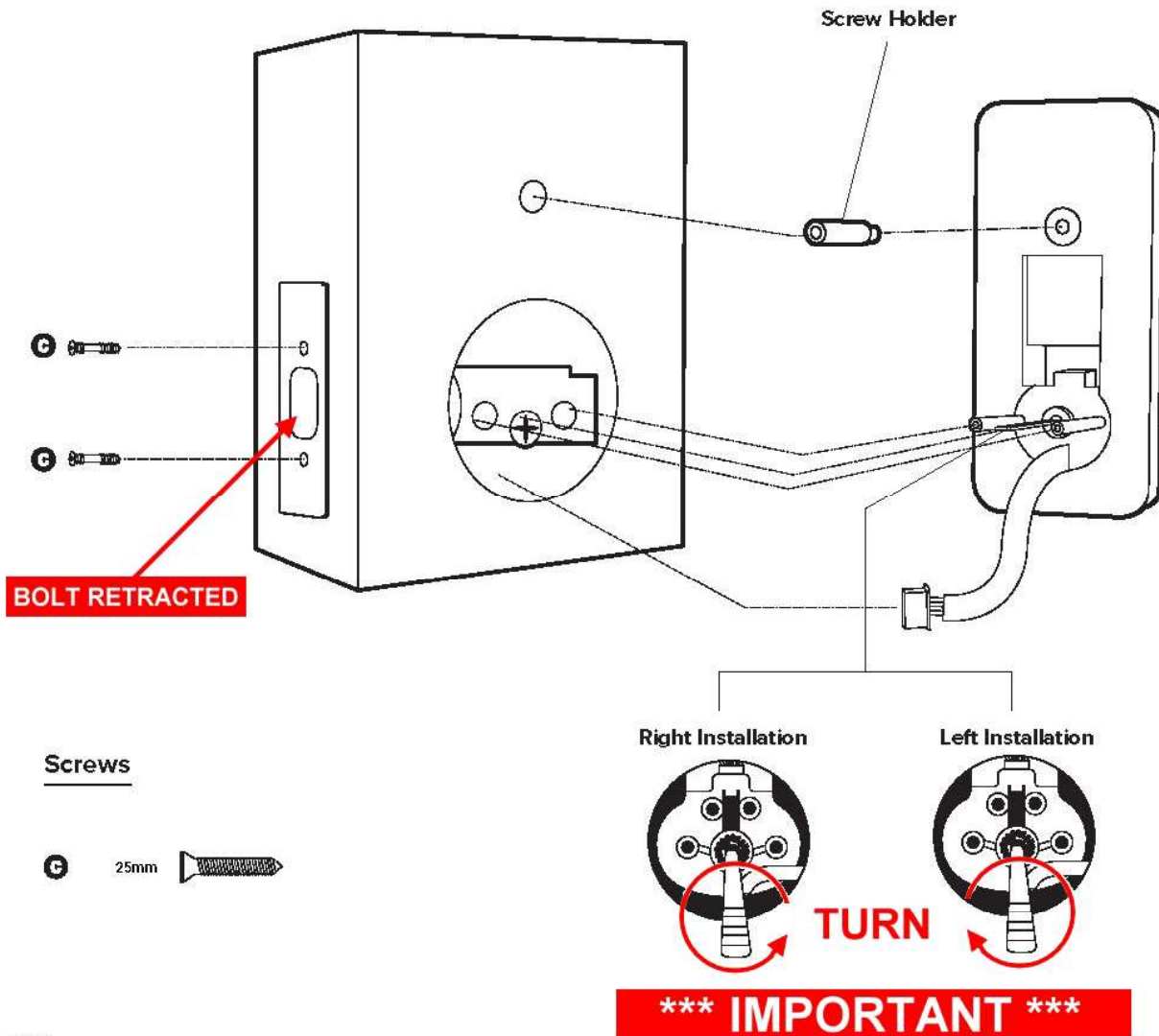

3

Secure the Front Assembly using the Back Plate

To do this, place the Back Plate (ensuring the correct side placement).

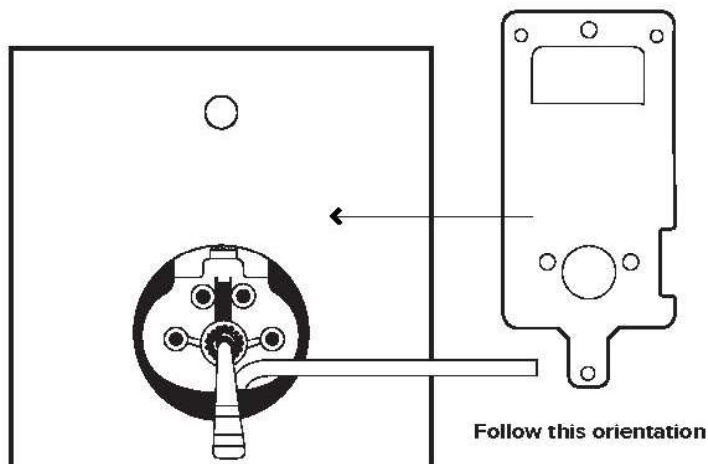

Screw it to the Front Assembly using the three 40mm screws.

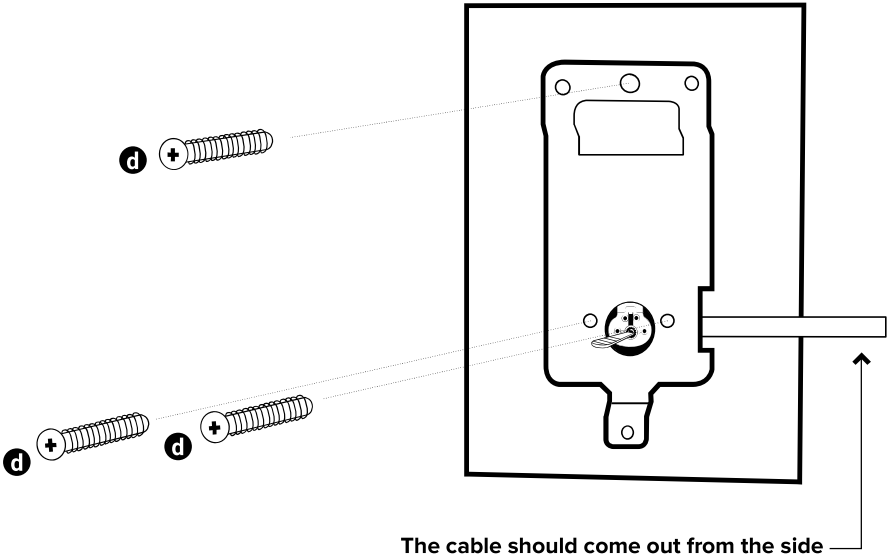

Screws

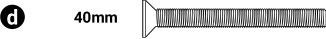

4 Connect Wire Connector

Connect the Wire Connector from the Front Assembly through the 54mm hole to the Back Assembly. Ensure that the wire is installed properly and securely.

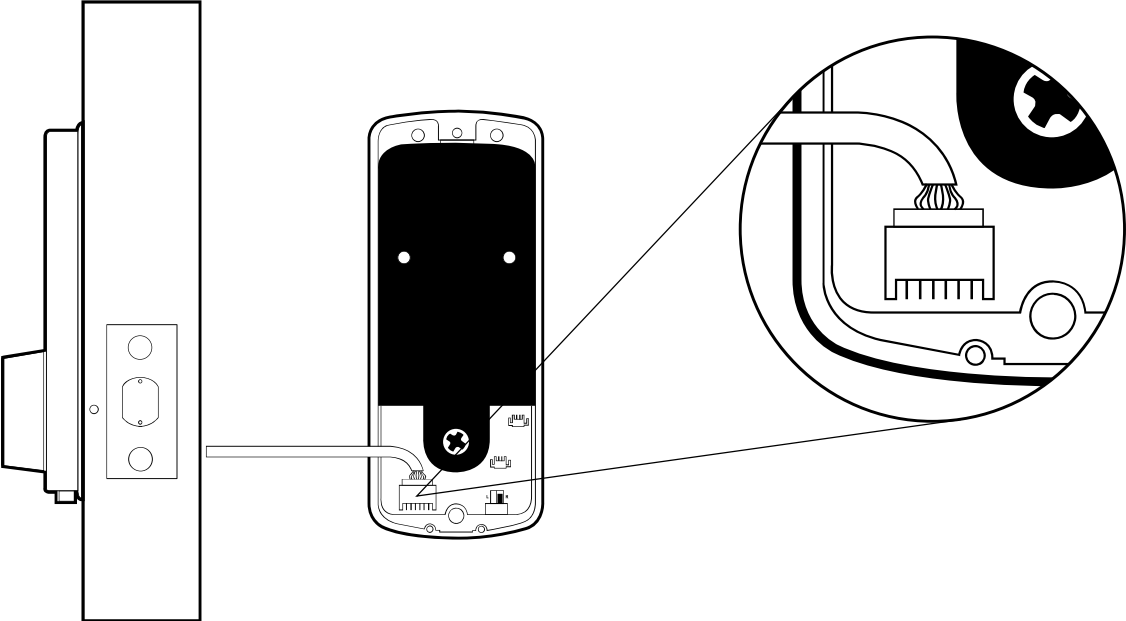

5 Fit Back Assembly to the Door Tailpiece

Ensure thumbturn position is turned to 'unlock' position.

Left Installation

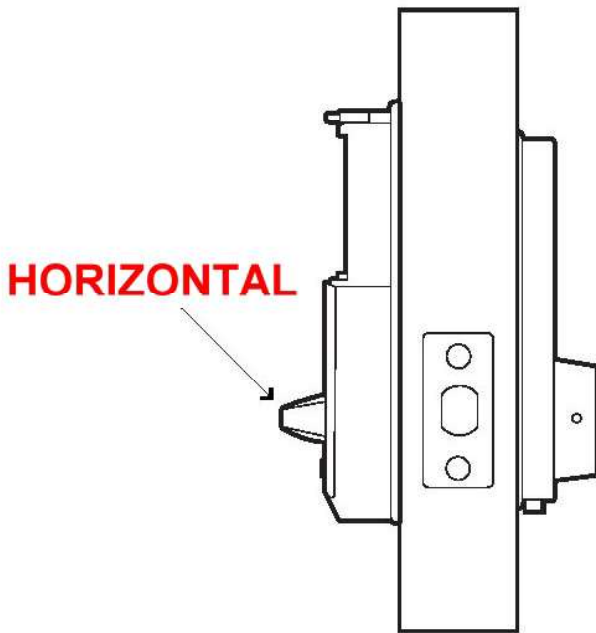

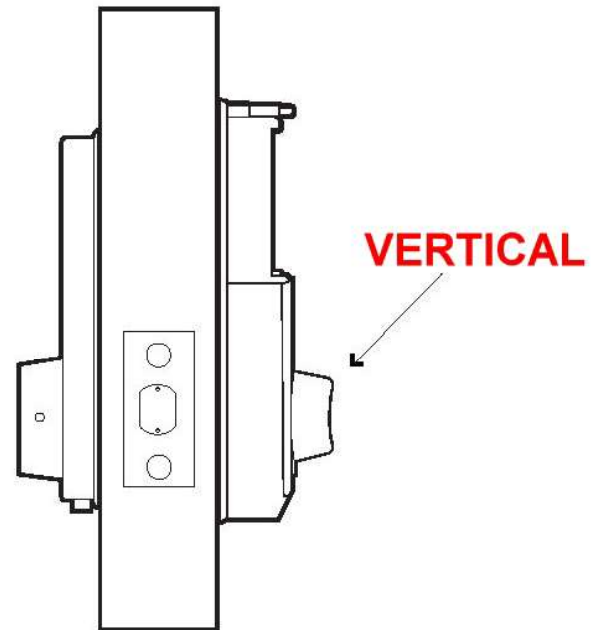

Right Installation



ALWAYS INSTALL WITH BOLTED RETRACTED !!!

6 Secure the Back Assembly

Screws

- a** 05mm 
- b** 22mm 

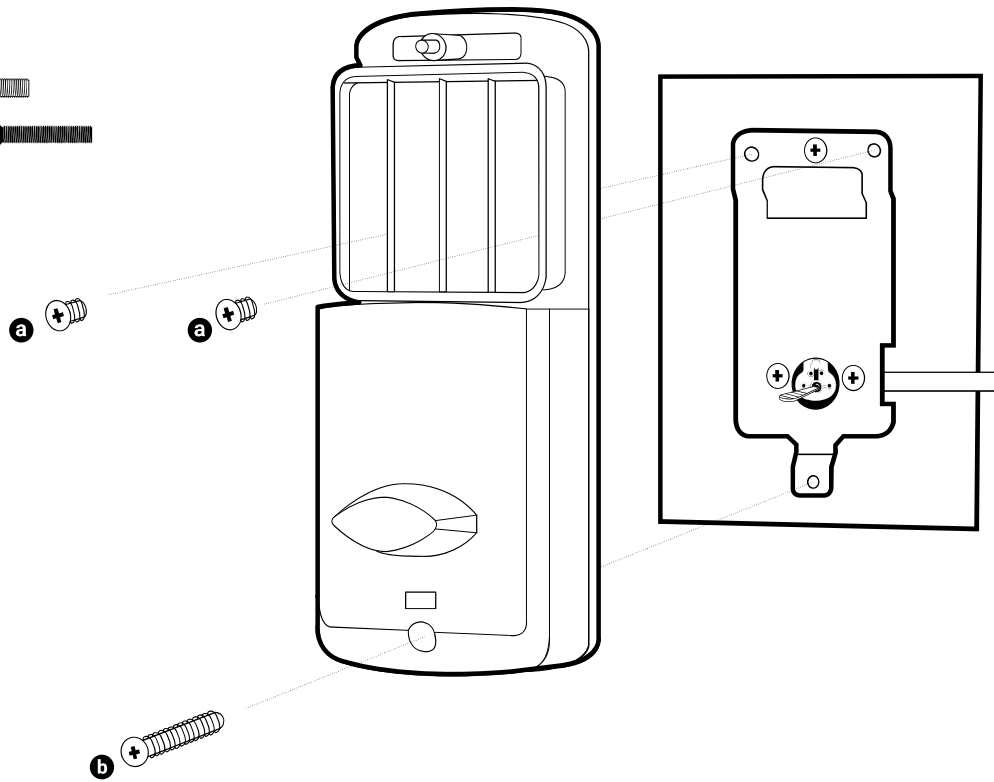

Insert 4 of AA Batteries

Before closing the battery case lid.

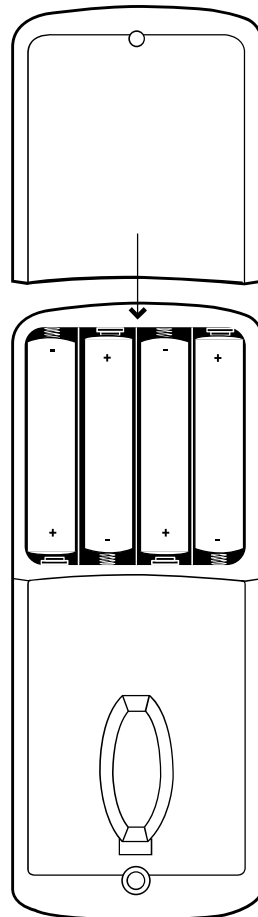

Test Lock

Place hand over your lock to activate touchpad and hold # to lock.

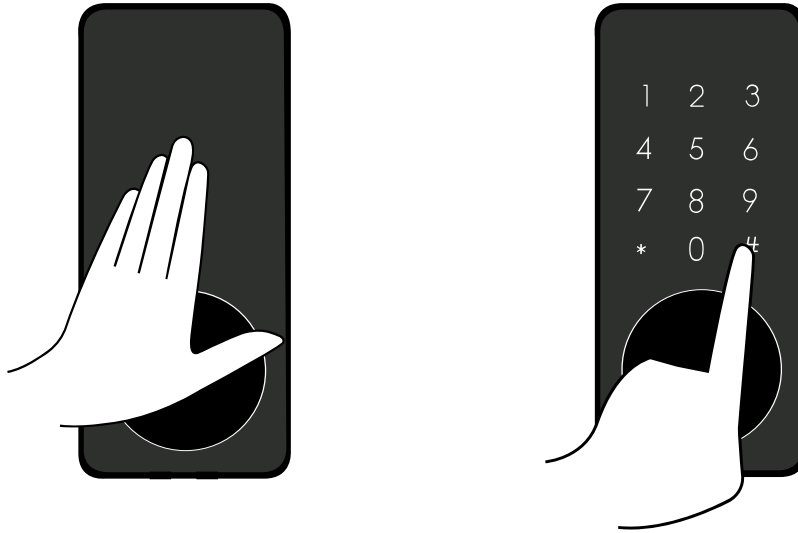

Does your bolt unlock?

Yes

Congrats!
Your lock is correctly installed.
Proceed to next steps.

No

Does the bolt tongue slide out when you turn the thumbturn?

Yes

Left-Right toggle incorrectly set

Troubleshoot: Try Setting the left-right toggle on your back assembly to the correct side. (See Pg. 10)

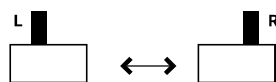

No

Tailpiece and/or thumbturn incorrectly set

Troubleshoot: Disassemble lock and install it again.

Still experiencing issues?
Contact Linnea Support for more help.

Preparing the Door Frame

1 Ensure to align the lock to the door frame and mark it down.

2 Mark out where the bolt tongue locks then drill a corresponding hole on door frame. Chisel to fit the strike plate in as well.

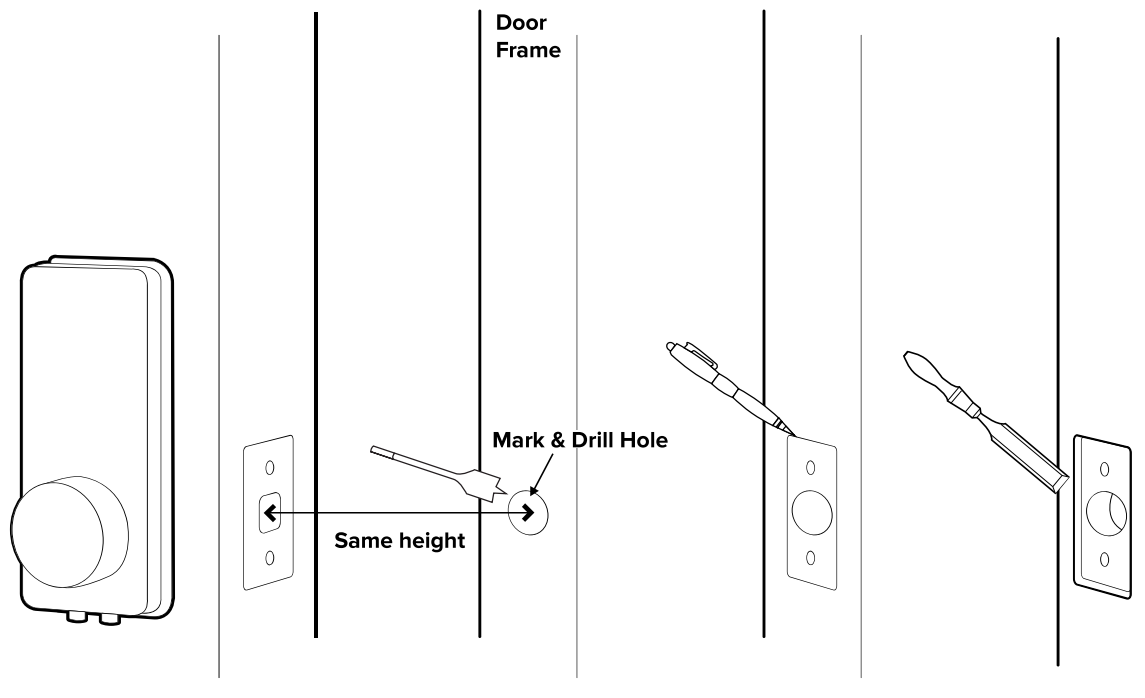

3 Secure strike plate housing and strike plate using 2 x 25mm wood screws.

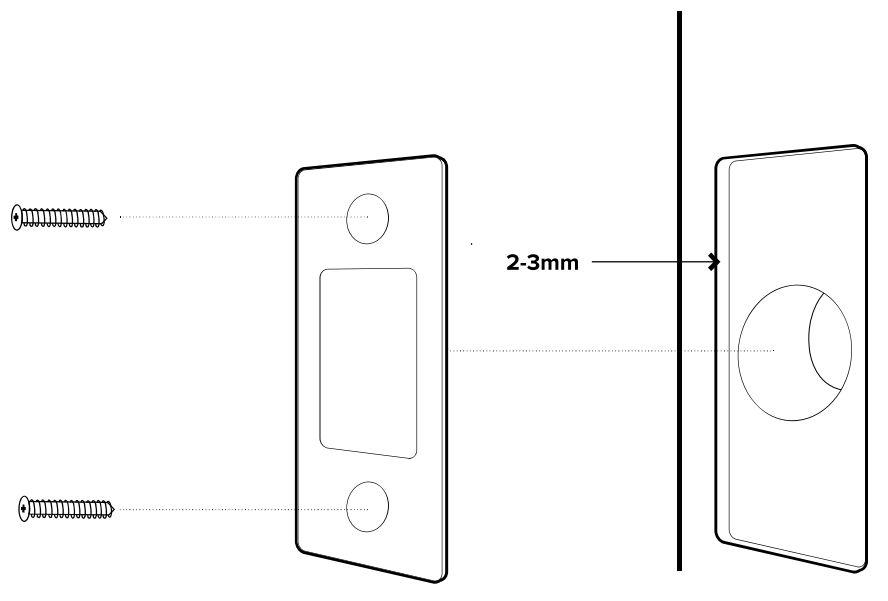

Pairing



TTLock
Smart Lock



Download TTLock app
from App Store/Google Play

Register

Register a new account or,

Log In

Login with an existing account on app

CHECKLIST

- Lock has not been paired
- The keypad stays awake during pairing
- Turn on your phone's Bluetooth and Internet connection

Setup **Bluetooth**

1. **Home** > **Add Lock** > **Lock**
2. Touch the keypad on the Smart Deadbolt and tap **Next** in the app to reveal active locks in range
3. Select your device
4. A chime will notify you that your phone is connected
5. Tap **Upload Data** to load the main menu (Lock Management)

Update App

Before proceeding, turn on your Bluetooth and ensure that you are within Bluetooth range of the lock.

To update app go to **Lock Management** > **Settings** > **Lock Upgrade**

Features

Passcode / Bluetooth Unlock

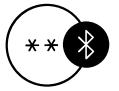

Bluetooth Master Key

The Linnea Smart Deadbolt unlocks with Bluetooth via the app.



Decoy Passcode Code

A total of 16 decoy digits including passcode can be entered to prevent the passcode from being exposed.



Bluetooth Guest Key

Bluetooth keys based on duration can be generated and shared with guests.



Master Passcode

The Linnea Smart Deadbolt unlocks with a permanent Master Passcode.



User Passcode

The mobile app can generate user passcodes, with validity duration from One-Time, Permanent, or a Duration based on Date-time.

Lock / Unlock



Timer Re-lock

After successfully unlocking, the Linnea Smart Deadbolt will re-lock after a period of time (between 5 to 120 seconds). The owner sets this function.



Manual Locking

Hold the '#' key for 2 seconds to lock the Linnea Smart Deadbolt.

Security / Alarms



Security Lockout Mode

After 5 consecutive unsuccessful attempts at entering a passcode, the Linnea Smart Deadbolt will sound an alarm and be unresponsive for 5 minutes. Physical key and Bluetooth Unlock can be used to unlock in this state.



Privacy Lockout Mode

Activate this from indoors to prevent entry from outsiders. Physical key can be used to unlock in this state.



Activity Logs

Entry via passcodes and Bluetooth Key will be logged in the app.

Bluetooth key access logs are updated in real-time and passcode access logs are updated when the owner uses a bluetooth key or update logs.



Tamper Alarm

The lock will sound if intruders try to pry the lock from the door.

Unlocking

To unlock the door

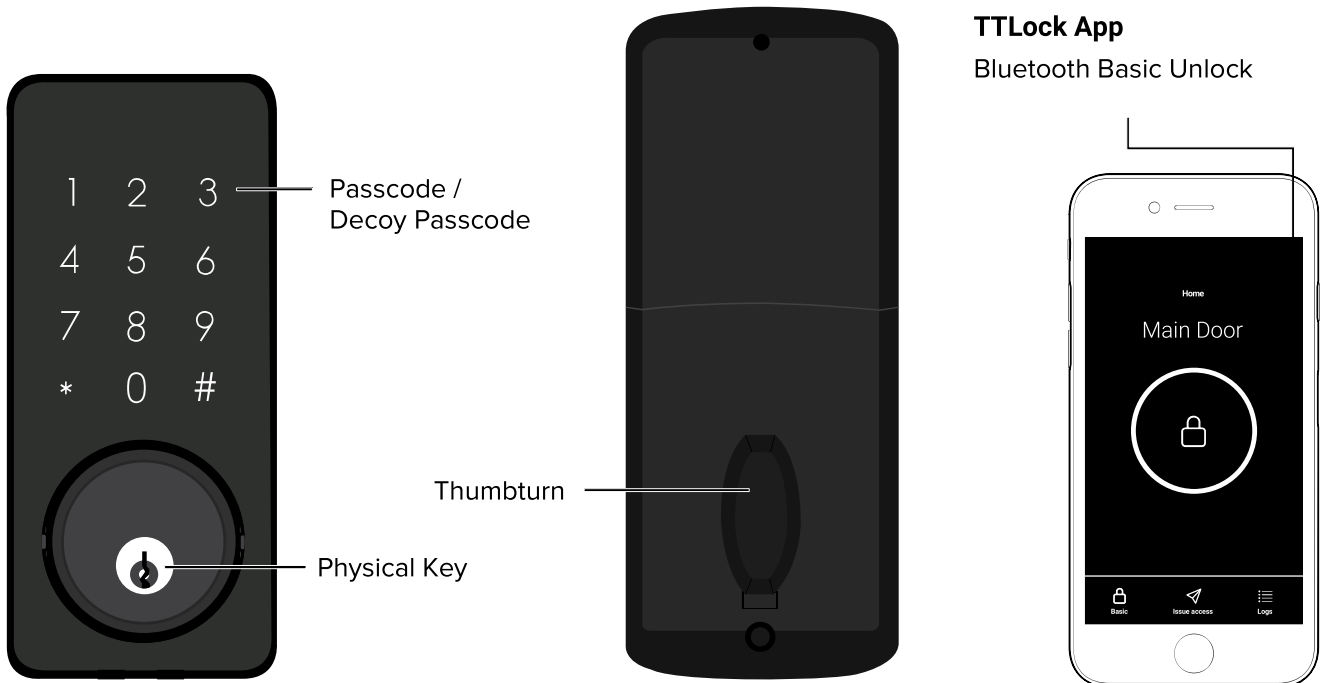

Legend



Passcode

Key in your passcode and press '#'



Decoy Passcode

Key in up to a total of 16 digits, including the passcode, followed by '#'



Bluetooth Basic Unlock

On your app, click on the Bluetooth Unlock button and tap on your lock



Bluetooth Guest Key

Refer to lock tutorial



Physical Key

Use the physical key to unlock the door



Thumbturn

Use thumbturn at the back of lock

Locking

To lock the door

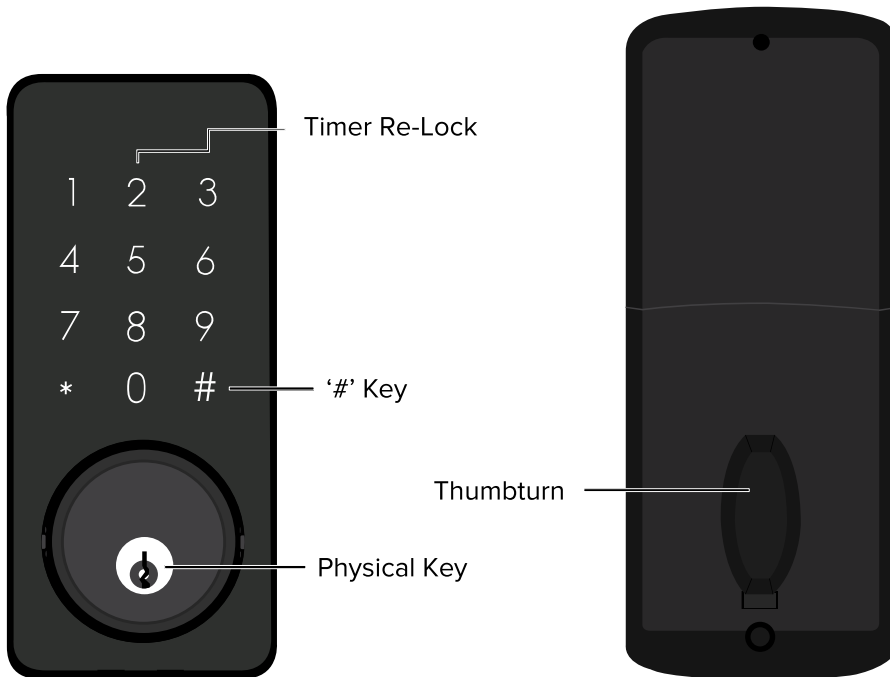

Legend



'#' Key

Press and hold '#'



Physical Key

Use the physical key to lock the door



Timer Re-Lock

Refer to Lock Tutorial - Step 7



Thumbturn

Use thumbturn at the back of lock



1 Default factory Passcode

In the factory mode (before pairing), the Passcode to unlock is * **1234567890** #

2 Setting Master Passcode

Before proceeding, turn on your Bluetooth and ensure that you are within Bluetooth range of the lock.

1. **Lock Management > Setting > Admin Passcode**
2. If prompted, enter your account password and tap **OK**.
3. Set admin passcode and save (this is your Master Passcode).

3 Adding new Passcode

New passcodes can be added from
Lock Management > “Send Passcode” > Select the passcode type from the top bar

Passcode Type	Description	Steps	Activate within*
One-time	Single-use, short term passcode *Must be used within 6 hours	Tap Generate	6 hours
Permanent	General use passcode	Tap Generate	24 hours
Timed	Passcode with set time frame	Set Active and Expire times > Generate	24 hours
Cyclic	Regularly occurring passcode	Set days > Set Active and Expire times > Generate	24 hours
Customized	Set your own passcode and time frame	Set Active and Expire times > Set Passcode > Enter 4-9 digit passcode * Must be done near the lock to become active	24 hours
Erase	Generate new passcode while deleting previous passcodes	Tap Generate	24 hours

*To activate, unlock once with the passcode. If unactivated within this period of time, the passcode will become invalid.

Lock Tutorial



4 Deleting Passcodes

To delete one at a time, go to **Lock Management > Passcodes > Long press on passcode > Delete**

To delete all passcodes at once, go to **Lock Management > Passcodes > Options** (upper right corner) > **Reset Passcode > Reset > Enter account password > OK**

* Master passcode cannot be changed via this method; refer to step 2.

* If at any time an error beep (4 consecutive beeps) is heard, restart the program from the beginning.

5 Activity Logs

To view the activity log, go to **Lock Management > Records**

Use the search bar to find specific records.

6 Ownership Transfer

The new owner will need to register a TT Lock account before proceeding.

To transfer ownership to another user, go to **System Settings > Transfer Locks > Select Lock > Next > Enter new owner's TLock user account > Next**

Change the master passcode under **Lock Management**.

Lock Tutorial



- on TLock App



- on Deadbolt Keypad

7 Enabling & Disabling Timer Re-Lock*



To Enable	* 2 1 # <Master Passcode> # <Duration between 5-120 seconds> #
To Disable	* 2 0 # <Master Passcode> #



To Enable	Lock Management > Setting > Auto Lock > Check the box next to Auto Lock > Set the time for the Auto Lock to engage (between 5 and 120 seconds) > OK
To Disable	Setting > Auto Lock > Uncheck the box next to Auto Lock

* By default, Timer Re-lock is disabled.

8 Privacy Lockout Mode



To prevent others from using passcode and Bluetooth Key to unlock while you are inside the property. Note: Physical key can be used to unlock in this mode.

To Activate	Press the Privacy Lockout button located below the thumb turn on the back of the lock. You will hear a long beep to indicate the keypad lockout is activated.
To Disable	Press the Privacy Lockout button located below the thumb turn on the back of the lock. You will hear a quick 2 beeps to indicate the keypad lockout is disabled.

9 Bluetooth Key Sharing

Bluetooth sharing allows you to share a Bluetooth Key with other users for mobile access. It allows your guests to unlock the Linnea smart lock via Bluetooth.

To create a Bluetooth Key, go to **Lock Management > Send eKey >**

Choose the type of eKey > Tap the icon next to “**Account**” to select the eKey recipient from your phone’s contacts list > Name the eKey as desired (contact list name is entered by default) > Set **Active** and **Expire** times > **Send**

To receive a Bluetooth Key, download the TLock app from iTunes or Google Play store and register/login to your account

** Note: Bluetooth Key must be accepted within 1 hour of generation before it expires*

To delete a Bluetooth Key, go to **Lock Management > eKeys > eKey Info > Delete**

10 9V Jumpstart Feature

Step 1 - Touch and hold the battery contacts against the 9V jumpstart pin on the lock and you will hear a series of beeps

Step 2 - While holding the 9V battery to the jumpstart, key in your passcode on the keypad followed by ‘#’ to unlock

Lock Behavior

	Security Lockout Mode	Privacy Lockout Mode
Activated by	5 consecutive invalid passcodes	Press the Privacy Lockout button located below the thumb turn on the back of the lock till you hear a long beep
Disable By	Wait for 5 Minutes Bluetooth Unlock Physical Key	Press Privacy Lockout Button Physical Key Thumbturn
Behavior	Keypad is flickering	Keypad does not light up
Duration	Unresponsive for 5 minutes	Unresponsive until Privacy Lock Mode is disabled

Troubleshoot

Pairing is unsuccessful

- Try with a different mobile device, using the same username and password
- Update your phone's operating system to the latest version
- Restart the Bluetooth and internet connection on your mobile device
- Restart TTLock app on your mobile device
- Switch to a new set of batteries

Keypad does not light up

- Use a 9V battery to jumpstart and switch to a new set of batteries
- Check if the Smart Deadbolt is in Privacy Lockout Mode

Keypad is flickering

- The Smart Deadbolt is low in battery. Switch to a new set of batteries

Generated passcodes do not work

- Make sure that the generated passcodes are activated within the given hours
- Do a Bluetooth Unlock to refresh the app
- Passcodes may have been customized or expired

Changing Batteries

- To open the battery compartment, push the pin at the top of the back assembly and slide the cover upwards
- Replace all four batteries

Lock is not working when battery level is not 100%

- Do a Bluetooth Key unlock to refresh the battery level on the app
 - Battery level shown in the app may not be accurate
 - Use Alkaline batteries only
 - Do not use: Heavy Duty, Eveready, GP, or rechargeable batteries
- * Using high quality batteries will improve the performance and lifespan of the lock

Bluetooth Key is not working

- Restart the Bluetooth and internet connection on your mobile device
- Check on the timezone of the home listing against your phone time
- Check if the Bluetooth Key is expired. It must be accepted within 1 hour of generation
- Update your TTLock app to the latest version
- Switch to a new set of batteries

Re-lock is not working

- Check battery level of the lock
- Make sure you have enabled timer re-lock

Keypad lights up on touch only

- Check if the Smart Deadbolt is in security lockout mode
- Refer to Lock Tutorial